

**Administration**

- ① Admin Offices

**Conference Center**

- ② Conference Center
- ③ H House
- ④ G House
- ⑤ F House
- ⑥ Thorn House

**Campus Features**

- ⑦ Tennis Court
- ⑧ Hayes Manor
- ⑨ Boxwood Garden
- ⑩ Deliveries
- ⑪ West Park

- Campus Entrance
- Ground Level Bldg Entrance
- Parking Garage Entrance
- Visitor Parking

**Campus Map**

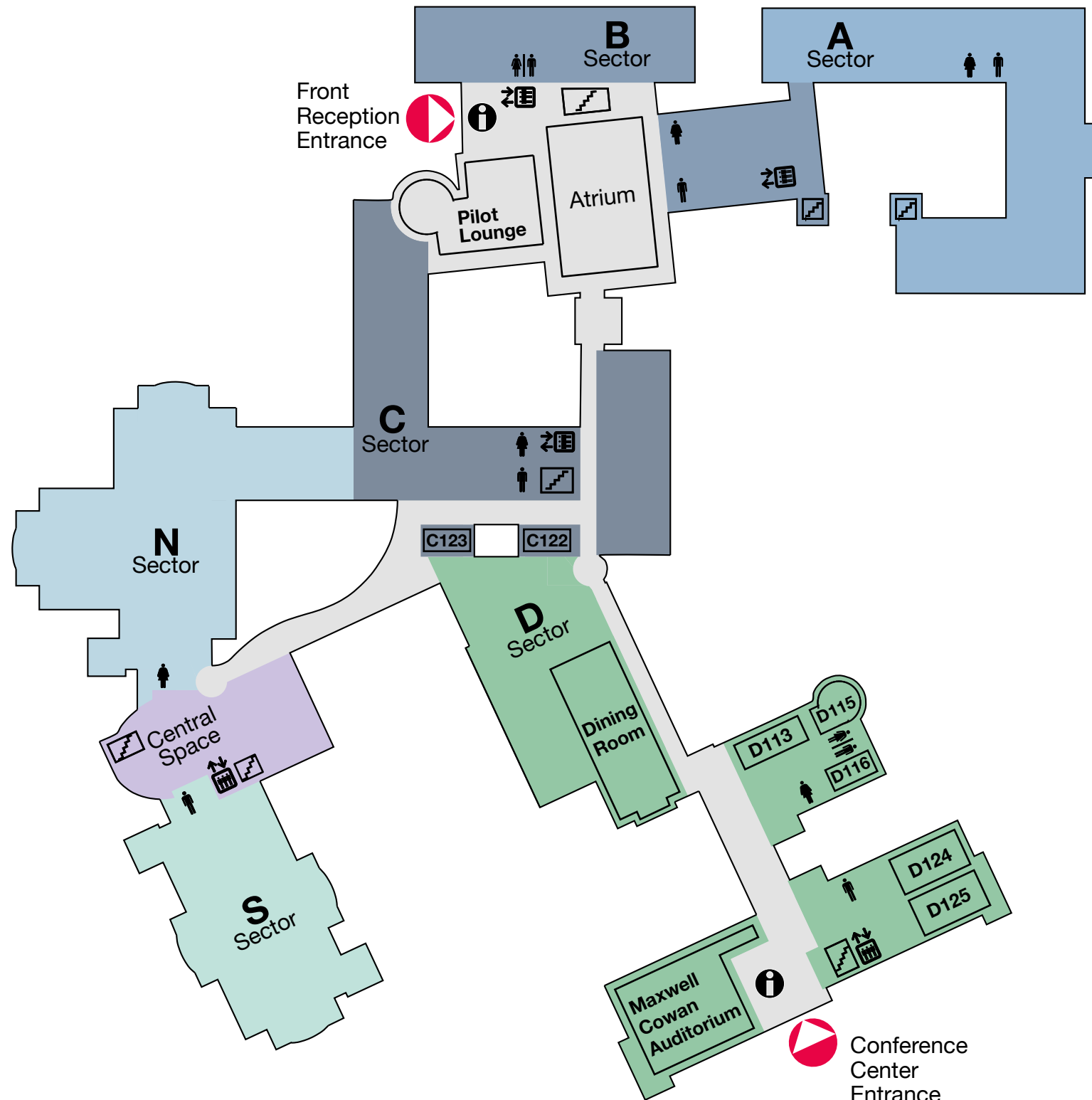

**Ground Level Plan**

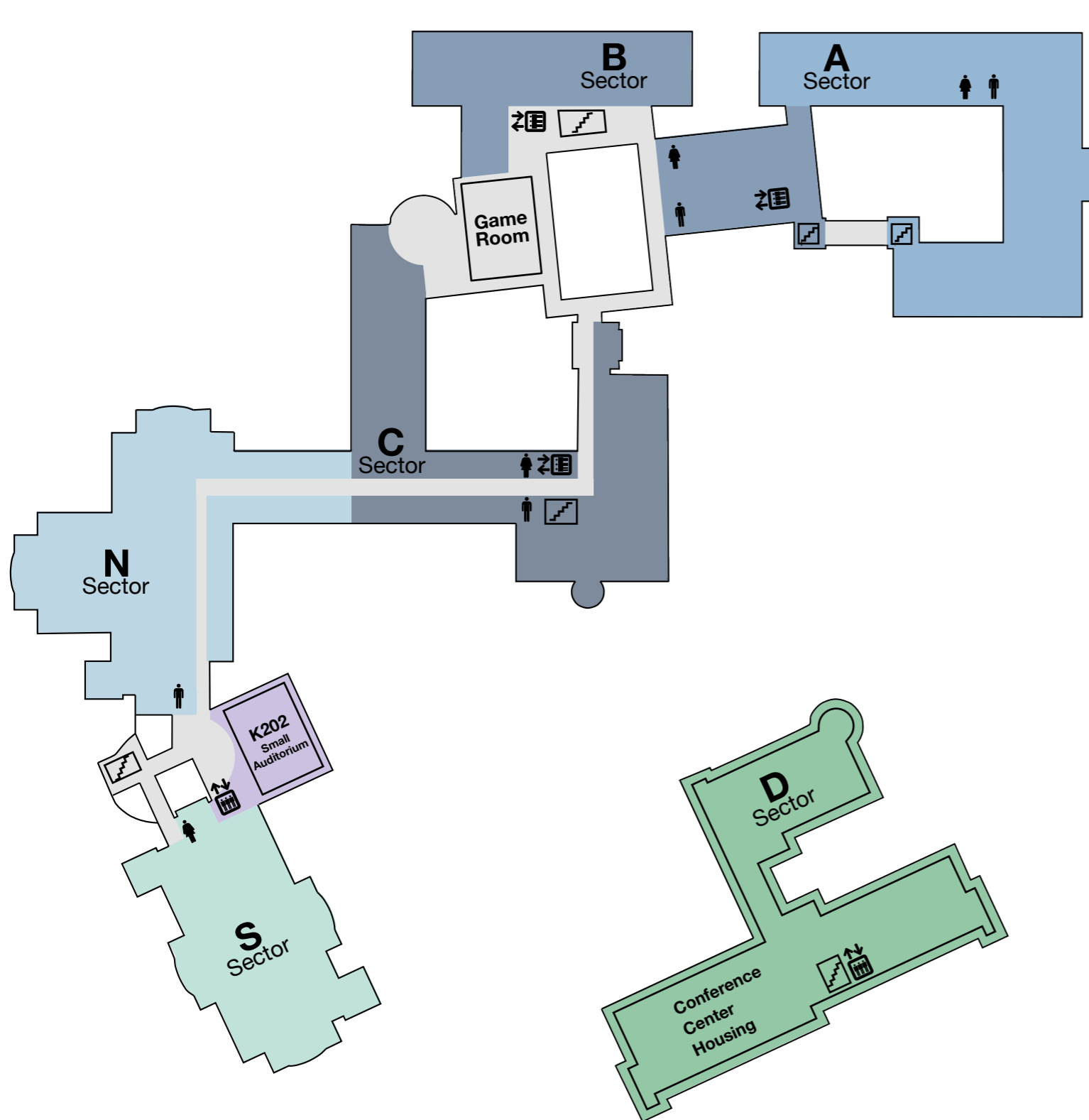

Upper Level Plan



Lower Level Plan